

Investing in People and Ideas



IRISH RESEARCH COUNCIL
An Chomhairle um Thaighde in Éirinn

Welcome
Céad Mile Fáilte

Dr Gemma Irvine
6th March 2013



Uachtaránacht na hÉireann ar
Chomhairle an Aontais Eorpaigh
Irish Presidency of the Council
of the European Union
eu2013.ie

IRELAND

Research Policy Drivers – Building Capacity

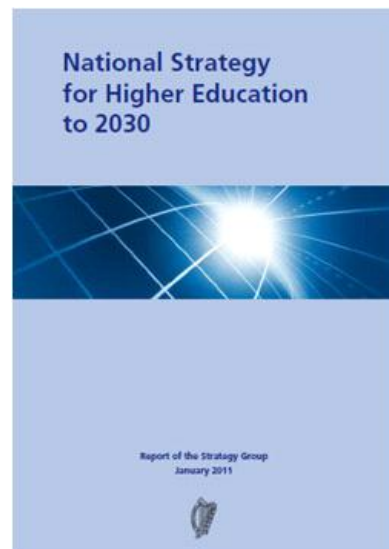
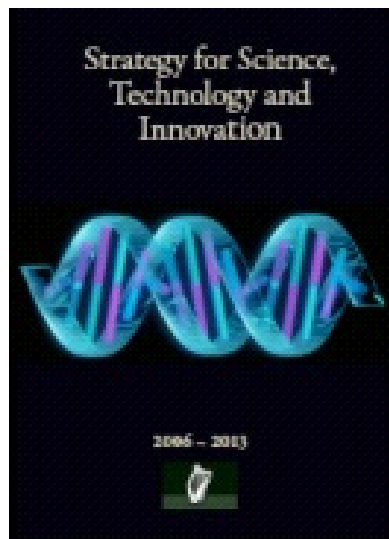

WHY IRELAND?

Research Performers

7 Universities

14 IoTs

5 Colleges

2 Educational Institutions



Top 1% of
research
HEIs in
world in 18
fields of
research

Research Funders

SFI

HEA/PRTL

EI

HRB



Public agencies
(Ag & Food, Env,
Marine, Energy)

Impact Relative to World

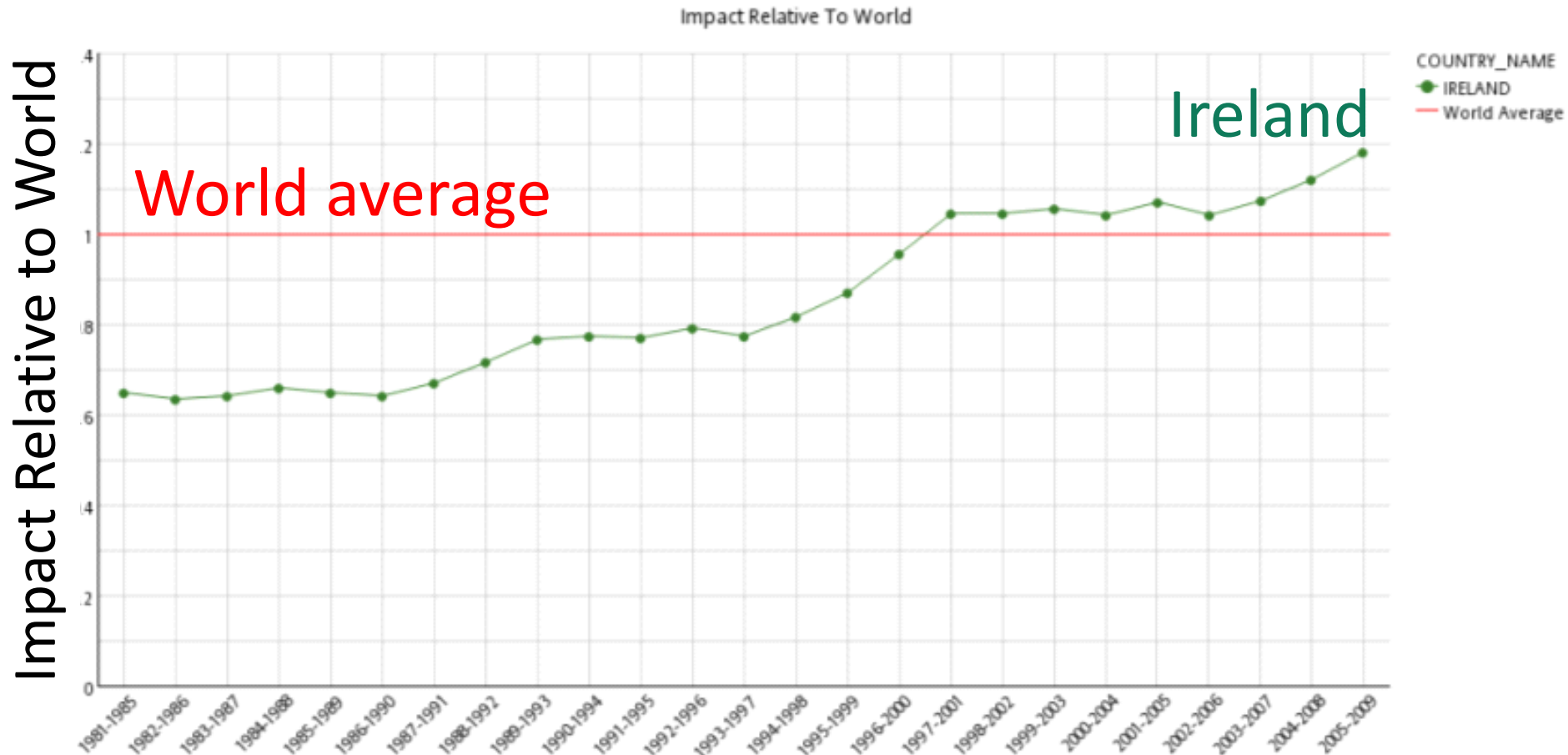

Two Councils become one



The mission of the Irish Research Council is to enable and sustain a vibrant and creative research community in Ireland



Excellence

Investing in Ideas

All Disciplines

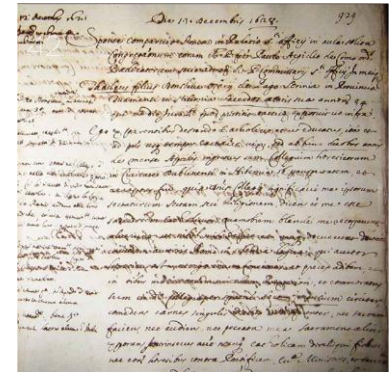



IRCHSS

MOSAIC

A Celebration of Irish Research in the Humanities and Social Sciences



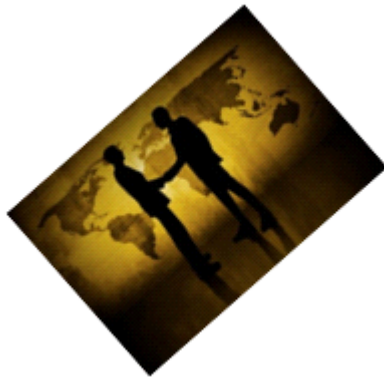

Excellence

Interdisciplinary

Investing in Ideas

**Exploratory
Research**

All Disciplines

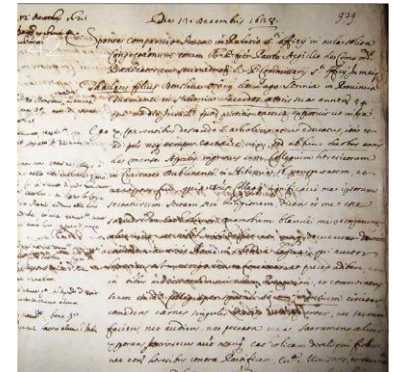

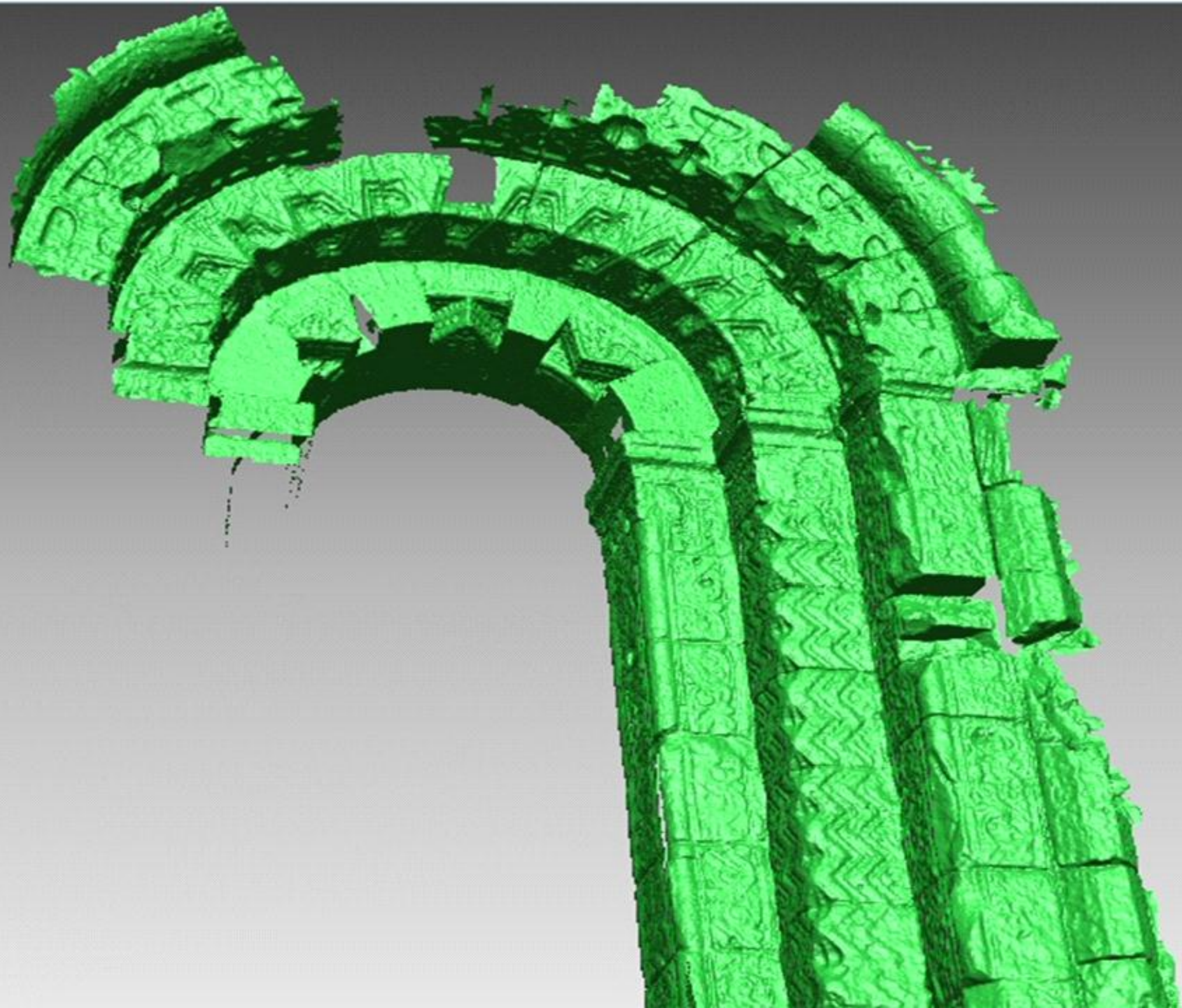

Individual researchers

Structure & transferable
skills

Investing in People

Early stage career
development

Policy advisory
role

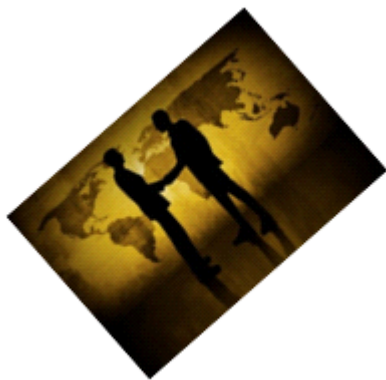

Excellence

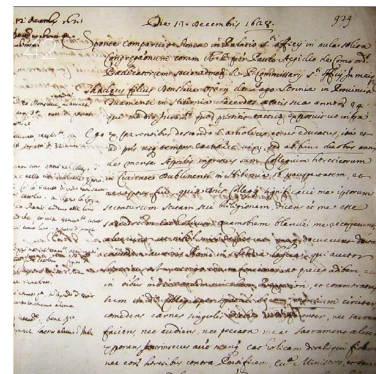

Interdisciplinary

Investing in Ideas

Exploratory
Research

All Disciplines



IRISH RESEARCH COUNCIL
An Chomhairle um Thaighde in Éirinn

IRC SCHEMES 2013

Postgraduate Scholarships	Government of Ireland	Deadline March 2013
	Enterprise Partnership Scheme	
	Andrew Grene Scholarship	
	Employment Programme	TBC
Postdoctoral Fellowships	Government of Ireland	Deadline March 2013
	Enterprise Partnership Scheme	
	Elevate Marie Curie International Mobility Fellowship	
PI led Schemes (AHSS only)	Government of Ireland Research Projects Grants Scheme	TBC
	Research Development Initiative	TBC
Networking & Travel Grants	Ulysses	TBC
	New Foundations	TBC

Postdoctoral Fellowships

Government of Ireland

1 year Fellowship



2 year Fellowship

Enterprise Partnership Scheme

Elevate Marie Curie International Mobility Fellowship



Government of Ireland (GOI) Postdoctoral Fellowships

-  1 year award – dissertation for publication
-  2 year award – new research project

Government of Ireland (GOI) Postdoctoral Fellowships

- ✿ 1 year award – dissertation for publication
- ✿ 2 year award – new research project
- ✿ Value of award
 - Salary €31,275k
 - PRSI & 20% pension (if applicable)
 - Eligible direct research expenses <€5,000pa

Government of Ireland (GOI) Postdoctoral Fellowships

- ✿ 1 year award – dissertation for publication
- ✿ 2 year award – new research project
- ✿ Value of award
 - Salary €31,275k
 - PRSI & 20% pension (if applicable)
 - Eligible direct research expenses <€5,000pa
- ✿ Full-time Fellowships held at a recognised Irish HEI (does not include Northern Ireland)

Eligibility for GOI Fellowships



 any nationality

Eligibility for GOI Fellowships



 any nationality

 have doctoral degree < 5years before call
deadline

Eligibility for GOI Fellowships

-  any nationality
-  have doctoral degree < 5years before call deadline
-  have research outputs

Eligibility for GOI Fellowships

-  any nationality
-  have doctoral degree < 5 years before call deadline
-  have research outputs

Must not

-  hold/have held a GOI or EPS Postdoctoral Fellowship before

Eligibility for GOI Fellowships

- ✿ any nationality
- ✿ have doctoral degree < 5years before call deadline
- ✿ have research outputs

Must not

- ✿ hold/have held a GOI or EPS Postdoctoral Fellowship before
- ✿ have been a Postdoc for >5yrs

Eligibility for GOI Fellowships

- ✿ any nationality
- ✿ have doctoral degree < 5years before call deadline
- ✿ have research outputs

Must not

- ✿ hold/have held a GOI or EPS Postdoctoral Fellowship before
- ✿ have been a Postdoc for >5yrs
- ✿ be a permanent member of staff at a Higher Education Institution at home or abroad

Enterprise-Academia-Social Engagement through Researchers

- ☐ Investing in people and ideas
- ☐ Building diverse research careers
- ☐ Options for Enterprise-Academia-Social engagement



Answers That Matter.







Enterprise-Academia-Social Engagement through Researchers

- ❑ Investing in people and ideas
- ❑ Building diverse research careers
- ❑ Options for Enterprise-Academia-Social engagement

❖ Enterprise Partnership Scheme

❖ Employment-Based Postgraduate Programme

❖ Elevate Postdoctoral Programme

❖ ENTERPRISE PARTNERSHIP SCHEME

 Researcher based in Irish HEI

❖ ENTERPRISE PARTNERSHIP SCHEME

- ❖ Researcher based in Irish HEI
- ❖ Placement in Enterprise Partner anywhere in world

❖ ENTERPRISE PARTNERSHIP SCHEME

- ❖ Researcher based in Irish HEI
- ❖ Placement in Enterprise Partner anywhere in world
- ❖ Value of award
 - Salary €31,275k pa
 - PRSI & 20% pension (if applicable)
 - Eligible direct research expenses <€5,000pa

❖ ENTERPRISE PARTNERSHIP SCHEME

- ❖ Researcher based in Irish HEI
- ❖ Placement in Enterprise Partner anywhere in world
- ❖ Value of award
 - Salary €31,275k pa
 - PRSI & 20% pension (if applicable)
 - Eligible direct research expenses <€5,000pa
- ❖ Project agreed between HEI & Enterprise Partner

❖ ENTERPRISE PARTNERSHIP SCHEME

- ❖ Researcher based in Irish HEI
- ❖ Placement in Enterprise Partner anywhere in world
- ❖ Value of award
 - Salary €31,275k pa
 - PRSI & 20% pension (if applicable)
 - Eligible direct research expenses <€5,000pa
- ❖ Project agreed between HEI & Enterprise Partner
- ❖ IP with HEI

❖ ENTERPRISE PARTNERSHIP SCHEME

- ❖ Enterprise Partner provides professional guidance and mentoring
- ❖ Access to experimental resources, facilities or data
- ❖ Commitment to co-fund at a rate of one third for the duration of the award



Value for Companies

Access to exceptionally talented pre-assessed researchers & potential future employees

Benefits for Researchers

Mentoring from Enterprise Experts

Value for Companies

Access to exceptionally talented pre-assessed researchers & potential future employees

Build research networks and collaborations with Irish Universities and Institutes of Technology

Benefits for Researchers

Mentoring from Enterprise Experts

Enhanced Employability

Value for Companies

Benefits for Researchers

Access to exceptionally talented pre-assessed researchers & potential future employees

Mentoring from Enterprise Experts

Build research networks and collaborations with Irish Universities and Institutes of Technology

Enhanced Employability

Low level of bureaucracy – Streamlined process from application to award

Transferable skills

Value for Companies

Benefits for Researchers

Access to exceptionally talented pre-assessed researchers & potential future employees

Mentoring from Enterprise Experts

Build research networks and collaborations with Irish Universities and Institutes of Technology

Enhanced Employability

Low level of bureaucracy – Streamlined process from application to award

Transferable skills

Maximise potential for innovation – People and Ideas

Exposure to commercially orientated research environment



Elevate Fellowship

- Marie Curie Co-funded 3-year Postdoctoral Fellowship Awards

Elevate Fellowship

➤ Marie Curie Co-funded 3-year Postdoctoral Fellowship Awards

Year 1: international host

Year 2: international host

Year 3: Irish host organisation maintaining link to international host

Elevate Fellowship

➤ Marie Curie Co-funded 3-year Postdoctoral Fellowship Awards

Year 1: international host

Year 2: international host

Year 3: Irish host organisation maintaining link to international host

2 Calls – 1st Call closing early 2013: 20 awards
(10 non-academic awards).

– 2nd Call closing early 2014: 25 awards
(15 non-academic awards).

Elevate Eligibility

- Experienced Researcher (ER) - any nationality < 5 years

Elevate Eligibility

- Experienced Researcher (ER) - any nationality < 5 years
- Resident of an EU or Associated Country



IRISH RESEARCH
An Chomhairle um Thai



Elevate Eligibility

- Experienced Researcher (ER) - any nationality < 5 years
- Resident of an EU or Associated Country
- Currently living in Ireland

Elevate Eligibility

- Experienced Researcher (ER) - any nationality < 5 years
- Resident of an EU or Associated Country
- Currently living in Ireland
- < 40% of ER career doing research outside Ireland

Elevate FINANCE

➤ **3 year Postdoctoral Fellowship individually calculated based on circumstances**

Elevate FINANCE

- **3 year Postdoctoral Fellowship individually calculated based on circumstances**
- **Total award, circa €87,000 pa**
 - Salary €65k (incl PRSI, pension)
 - mobility/travel €11k pa (with/without family)
 - research costs €10k pa
 - health insurance

Elevate FINANCE

- **3 year Postdoctoral Fellowship individually calculated based on circumstances**
- **Total award, circa €87,000 pa**
 - Salary €65k (incl PRSI, pension)
 - mobility/travel €11k pa (with/without family)
 - research costs €10k pa
 - health insurance
- **Cost to non-HEI, circa €26k pa (x3 = c€78k)**

Elevate FINANCE

- **3 year Postdoctoral Fellowship individually calculated based on circumstances**
- **Total award, circa €87,000 pa**
 - Salary €65k (incl PRSI, pension)
 - mobility/travel €11k pa (with/without family)
 - research costs €10k pa
 - health insurance
- **Cost to non-HEI, circa €26k pa (x3 = c€78k)**
- **Researcher is an employee of the Irish Host for the duration of the award**

Host Commitment

- ✿ International Host provides professional guidance and mentoring
- ✿ Access to experimental resources, facilities or data
- ✿ Commitment to co-fund at a rate of one third for the duration of the award



Value for Companies

Access to exceptionally talented pre-assessed researchers & potential future employees

Benefits for Researchers

Mentoring from Enterprise Experts

Value for Companies

Benefits for Researchers

Access to exceptionally talented pre-assessed researchers & potential future employees

Mentoring from Enterprise Experts

Build research networks and collaborations with Irish Universities and Institutes of Technology

Enhanced Employability

Value for Companies

Benefits for Researchers

Access to exceptionally talented pre-assessed researchers & potential future employees

Mentoring from Enterprise Experts

Build research networks and collaborations with Irish Universities and Institutes of Technology

Enhanced Employability

Low level of bureaucracy – Streamlined process from application to award

Transferable skills

Value for Companies	Benefits for Researchers
Access to exceptionally talented pre-assessed researchers & potential future employees	Mentoring from Enterprise Experts
Build research networks and collaborations with Irish Universities and Institutes of Technology	Enhanced Employability
Low level of bureaucracy – Streamlined process from application to award	Transferable skills
Maximise potential for innovation – People and Ideas	Exposure to non-academic research environment

EU Networks & Opportunities



NORFACE – Welfare States Futures Programme

- 15 Social Sciences Research Councils*
- Welfare in the 21st century
- At least 3 different eligible countries
- Projects < 3 years, < €1.5m budget
- PIs in Ireland must be full-time members of the academic staff
- DEADLINE 16th APRIL 2013
- WWW.NORFACE.ORG



NORFACE
ERA-NET

*Austria, Denmark, Estonia Finland, France, Germany, Iceland, Ireland, the Netherlands, Norway, Poland, Portugal, Slovenia, Sweden and the United Kingdom.



IRISH RESEARCH COUNCIL
An Chomhairle um Thaighde in Éirinn

WWW.RESEARCH.IE



INFO@RESEARCH.IE



@IRISHRESEARCH



FACEBOOK.COM/IRISHRESEARCH



AN ROINN | DEPARTMENT OF
OIDEACHAIS | EDUCATION
AGUS SCILEANNA | AND SKILLS



National Development Plan 2007 - 2013

Postdoctoral Fellowships

Postdoctoral (Empower,*Inspire and GOI Postdoctoral Fellowship)

Year	Applications	Awards	Success Rate (%)
2010	683	58	9
2011	476	71	15
2012	434	51	12
Total	1593	180	

*(*2010 only)*

PI led Schemes and Networking & Travel Grants

PI led Schemes (AHSS only)	Government of Ireland Research Projects Grants Scheme	TBC
	Research Development Initiative	TBC
Networking & Travel Grants	Ulysses	TBC
	New Foundations	TBC

WHY IRELAND?

Policy focus of funding agencies	Main Agency
Strategic Institutions - prioritisation and track record; collaborative networks and development of national hubs	PRTL
Physical Infrastructure incl. specialised facilities - all disciplines (Seed funding)	PRTL
Structured PhD programmes	Irish Research Council/ PRTL
Individual awards; postgraduate students + early stage career researchers) – all disciplines; targeted initiatives with employers	Irish Research Council
Areas of strategic interest (economic)– BIO, ICT, Energy, New Technology (Focus programmatic, teams and mid/late stage career researchers awards)	SFI
Focus on Industry facing collaboration – longer term research	SFI
Funds innovation partnerships HEIs/private sector – nearer market	EI
Funds commercialisation and knowledge transfer	EI
Funds strategic research areas (economic and public good) e.g. Health, Agriculture, Marine, Environment	HRB, DAFF, DOE
'Problem solving'/sectoral research	Others

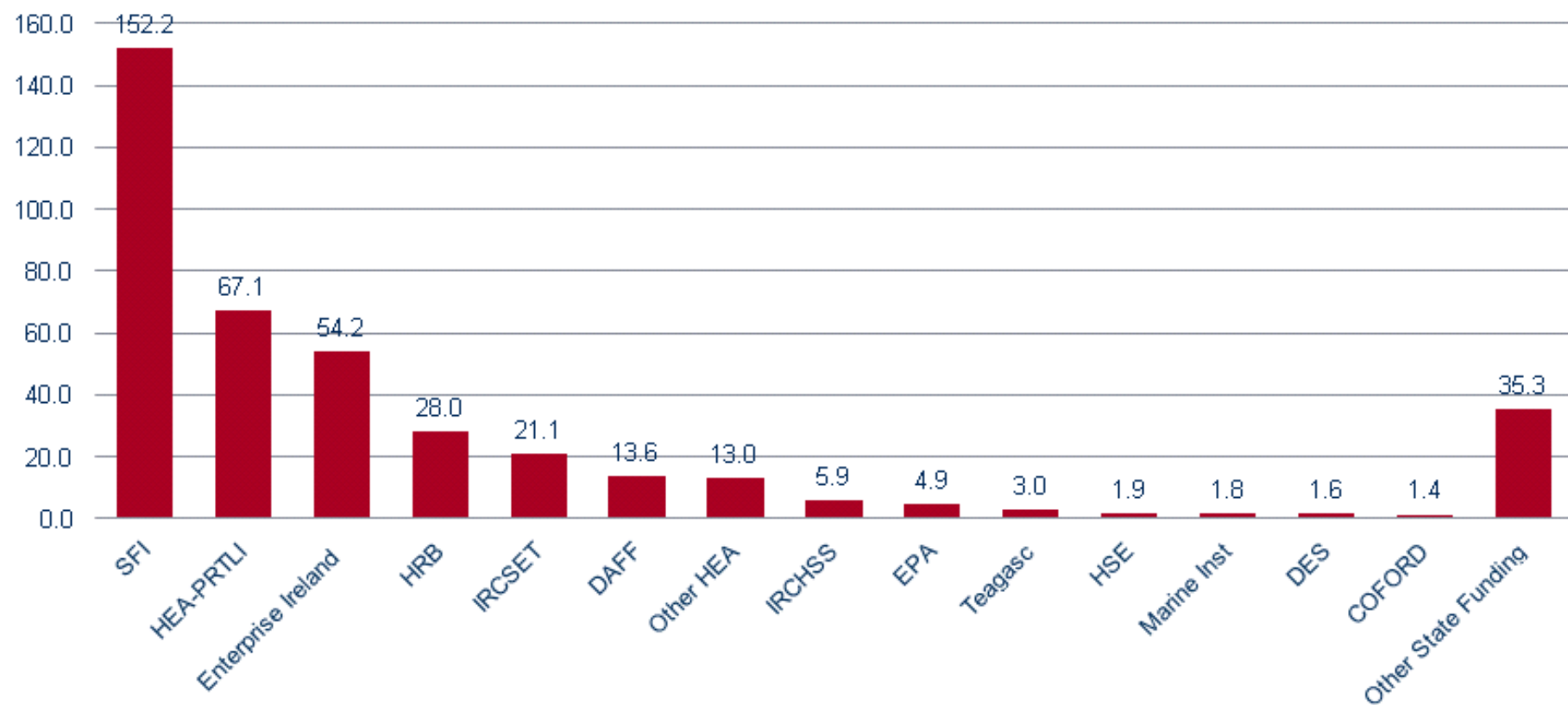

Success in FP7

	Applicants in Submitted Proposals	Applicants in Successful Proposals	Success Rate %
Ireland	4,965	1,137	23.0%

	Funding Requested by Applicants (€)	Funding Granted to Applicants (€)	Success Rate %
Ireland	1,703,357,658	361,917,578	21.0%

***Source: FP7 Ireland import of eCORDA release
(post cleaning and addition of Marie Curie financial contributions)**



**Ireland's FP7 drawdown: €361.9M
1.49% of the available budget
i.e. above Ireland's target of 1.25% from 2007-2013**



IRISH RESEARCH COUNCIL
An Chomhairle um Thaighde in Éirinn

[Home](#) [Small Text](#) [Large Text](#)

Important Links

Search



[RSS](#) [EMAIL](#) [PRINT](#)

[About Us](#)

[Funding Opportunities](#)

[Awards Made](#)

[European / International Projects](#)

[News & Events](#)

[Contact Us](#)

WHO WE ARE

Welcome to the website of the Irish Research Council. We hope you will find this site a useful portal to learn more about the Irish Research Council. The Research Council's programmes have been funded by the Irish Government under the

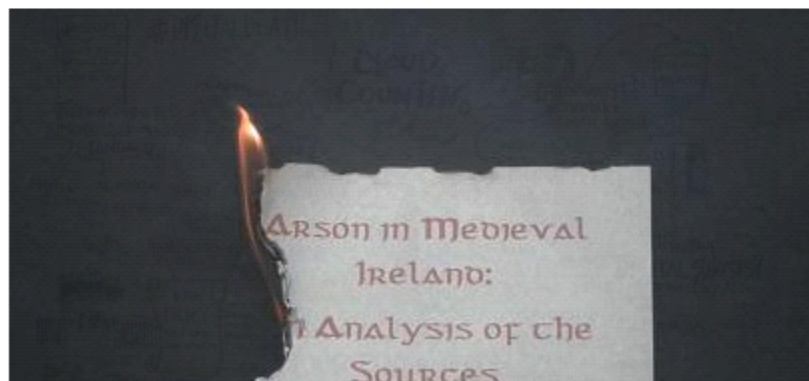

Research Showcase
Arson in Medieval
Ireland



IRISH RESEARCH COUNCIL
An Chomhairle um Thaighde in Éirinn



